

## Kit B – Bathroom Door - Locking

### Application:

- Bathroom locking within commercial office buildings, that have a requirement to be locked.
- **Door weight:** Suitable for fire doors up to 80kg
- **Door dimensions:** Suitable for fire doors up to 1100mm
- **Hinges:** 2 ball bearing, 3 pack, 102x76x3mm stainless steel material, template drilled, c/w timber door fixing screws. Suitable for doors weighing up to 120kgs.
- **Door closing device:** Template adjustable power size 2-4, die cast aluminium body, scissor arm with parallel arm bracket, maximum opening angle 105°, closing and latching speed
- **Mortice bathroom lock:** 76mm case size, 5mm or 8mm follower, 20mm single throw steel laminated deadbolt
- **Lever Handle Set:** 19mm return to door shape, 6mm rose, 8mm spindle, stainless steel material
- **Disabled Indicator & Turn:** 6x52mm diameter, stainless steel material,
- **Signage:** 76mm diameter, stainless steel material, "Fire door keep shut", drilled and countersunk c/w timber door pozi driv screws
- **Intumescent kits:** 1mm thickness mono-ammonium phosphate material, suitable for use on 30 or 60 minute timber fire doors  
\*Refer to fire door test evidence for further details\*
- **Carton dimensions:** 508mm x 201mm

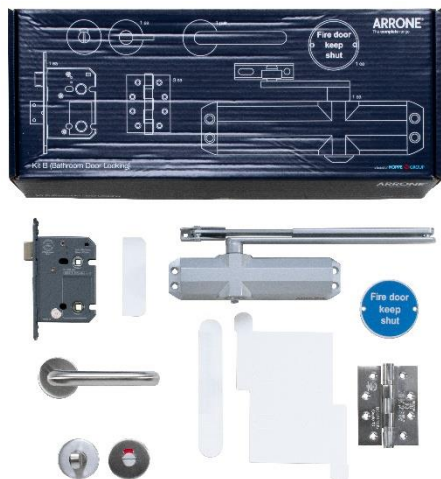

Product ref.	Article description	Finish	Article no.
<b>AR-FD/KIT-B</b>	Fire Door Hardware Kit - B, Bathroom Door, Locking, ARRONE Branded	N/A	<b>50012952</b>

## Kit B – Bathroom Door - Locking

### Kit Part Numbers:

Product ref.	Article description	Finish	Article no.
<b>AR8187-SSS</b>	Ball Bearing Hinge (1.5 Pair), 102x76x3mm, Square, SSS	SSS	<b>87109450</b>
<b>AR6800-SE</b>	Size 2-4 Door Closer, Silver Enamel	SE	<b>87105960</b>
<b>AR/INT-8180/8580</b>	Intumescent Pack, 1mm, to suit 102x76mm Hinge Range, Pack of 6	N/A	<b>50004578</b>
<b>AR8023-76-5/8-SC</b>	Bathroom Mortice Lock, 5mm or 8mm Follower, 76mm, SC Finish	SC	<b>87142896</b>
<b>AR/INT-8003/8004/8023-76-1</b>	Intumescent Pack, 1mm, to suit AR8003, AR8004, AR8023 locks, 76mm Case Size	N/A	<b>50012174</b>
<b>AR961/60-SP-SSS</b>	SS304 19mm Sprung RTD Lever on 6mm Rose, Satin Stainless Steel (F69)	SSS	<b>87109372</b>
<b>AR961/69D-SSS</b>	SS304 Disabled Indicator & Turn 6mm Rose, Satin Stainless Steel (F69)	SSS	<b>87109379</b>
<b>AR902-SSS</b>	"Fire Door Keep Shut" Sign, 76mm Diameter	SSS	<b>8511284</b>

- **Testing:**  
**Hinges** - BS EN 1935  
**Door closing devices** - BS EN 1154  
**Lever Handle Sets** - BS EN 1906  
**Locks and latches** - BS EN 12209  
**Fire testing** - BS EN 1634-1
- **CE Marked:** Hinges (AC0070), Door closing device (AD0095), Mortice bathroom lock (AG0103)
- **UKCA Marked:** Hinges (AC7678), Door closing device (AD7696), Mortice bathroom lock (AG7656)
- **CERTIFIRE Approved:** Hinges (CF369), Door closing device (CF603), Mortice bathroom lock (CF577)
- **Ironmongery finish:**  
 SSS – Satin Stainless Steel  
 SE – Silver Enamel  
 SC – Satin Chrome

**Important note:** The essential items of hardware in this fire door kit have been successfully included in fire tests to BSEN 1634-1 and where required as a mandatory measure, individually CE marked in accordance with the requirements of that item's related harmonised European standard.

Please refer to the door manufacturers own fire test evidence to ensure compatibility of the hardware items and the door set as a fire tested door set before specification or supply.